



Wall Graphic Instructions

Wall graphics are removable for up to 6 months under normal circumstances. Avoid applying to freshly painted walls (wait 7 days after painting) and we recommend asking a friend for help when applying. Removal should be done at a 180° angle while pulling slowly.

Included supplies:



Squeegee



Tape strips (x 10)



Unroll your wall graphic and discard the brown kraft paper.



Flip the wall graphic over and place face down on a clean surface.

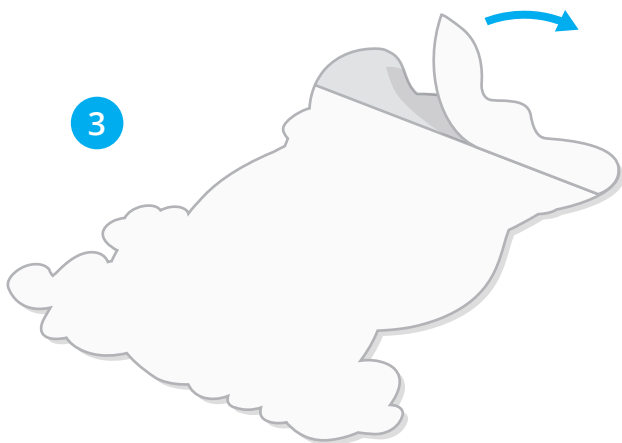

If your wall graphic is larger than 2 ft, you'll notice a back slit line toward the top. Peel off the top section of the backing and discard.

Note: If your wall graphic is smaller than 2 ft, you can simply peel the entire backing and apply to your wall.



With the adhesive exposed at the top, stick the wall graphic to a clean wall. Our adhesive is repositionable so you can adjust it to your liking.

Apply a few strips of tape to the top of the wall graphic to secure its position.

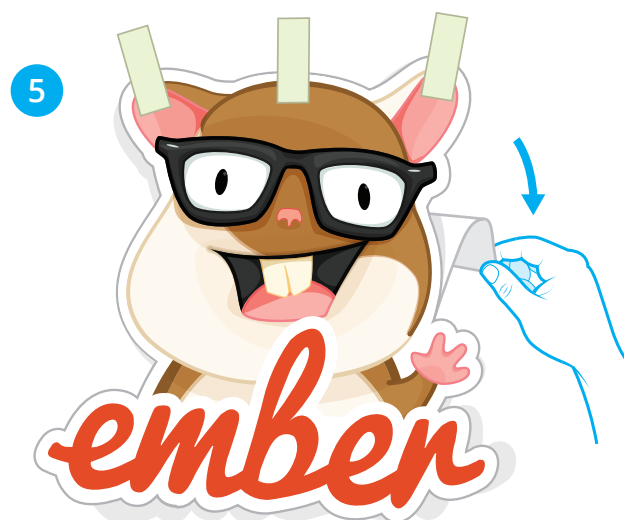

Reach behind the wall graphic and begin peeling the rest of the backing off.

With the other hand, smooth and apply the graphic to the surface using your hand or the supplied squeegee, working from the center out.

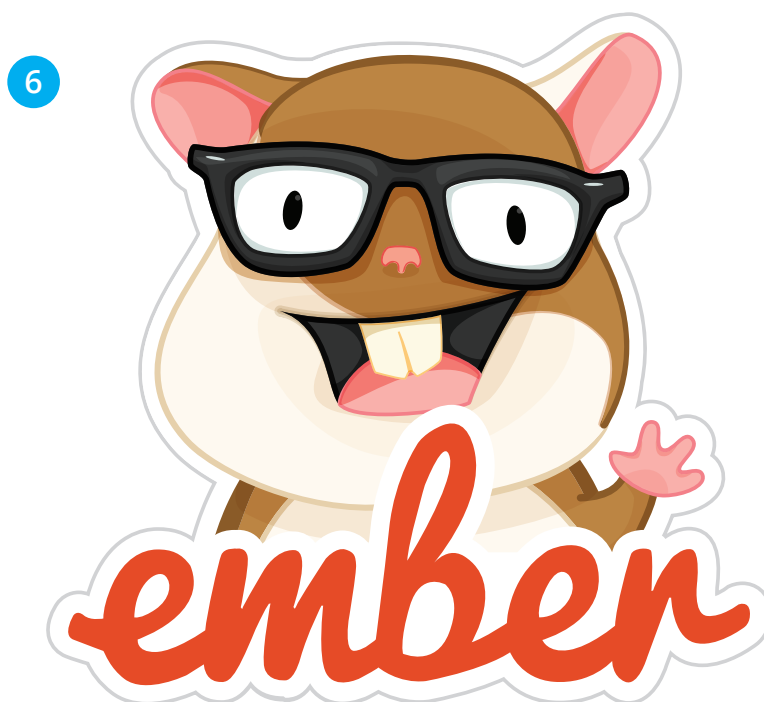

Remove and discard the tape strips and celebrate your awesomeness!